

Threaded End Connection

Series F Aluminum Bronze

- Lever Operated Ball Valve
- To 3000 PSI WP
- 1" Through 2"
- Bolted Body Construction



Material Description

| ITEM | PART NAME | MATERIAL NACE (STANDARD) |
|------|---------------------|--------------------------|
| 1 | Handle* | Carbon Steel |
| 2 | Handle Bolt | Standard Hex Bolt |
| 3 | Weather Guard | Polyethylene |
| 4 | Lock Plate Retainer | Stainless Steel |
| 5 | Lock Plate | Stainless Steel |
| 6 | Dust Cover | Polyethylene |
| 7 | Stop Plate Retainer | Stainless Steel |
| 8 | Stop Plate | Stainless Steel |
| 9 | Stem O-Ring | Fluorocarbon |
| 10 | Stem Seal | TFE |
| 11 | Stem | 316 Stainless Steel |
| 12 | Ball | 316 Stainless Steel |
| 13 | Ball Seat | Nylon (TFE Optional) |
| 14 | Body O-Ring | Fluorocarbon |
| 15 | End Adapter | ASTM B148-9D (955) |
| 16 | Body | ASTM B148-9D (955) |
| 17 | Body Stud Bolts | ASTM A193 B7M |

*Handle is optional. Ball valves can also be operated with a standard open-end wrench.

- Enhanced Protection Against CO₂ and Saltwater Corrosion
- NACE Standard
- Minimizes Risk of Galling Associated with Stainless Steel
- Multi-Seal Seats
- Fire Safe Design
- Rugged Locking Device Standard
- Maintenance Free

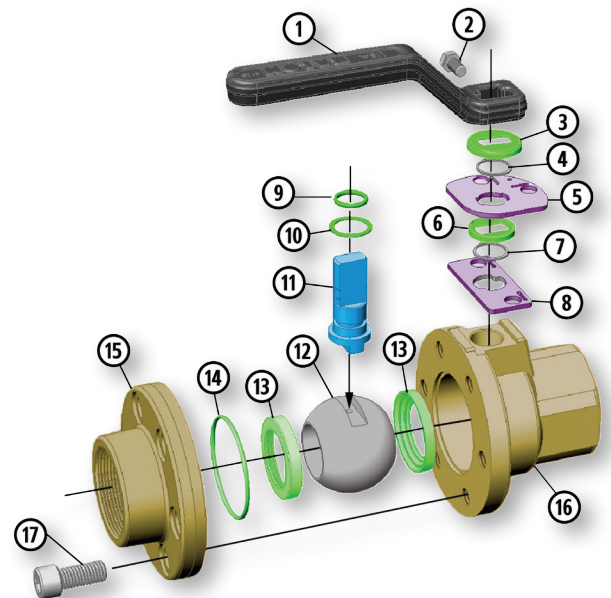
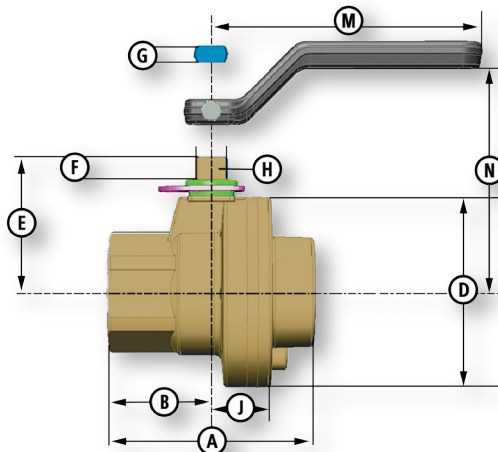

Dimensional Data

| SIZE | CATALOG | PORT | WP | A | B | D | E | F | G | H | J | M | N | LBS. | HANDLE | Cv |
|---------|------------|------|------|------|------|------|------|-----|------|------|------|-------|------|------|-----------|-----|
| 1x1x1 | 1F-F04N-SE | 1 | 3000 | 3.87 | 1.93 | 3.37 | 2.37 | .50 | .340 | .685 | 1.12 | 4.37 | 2 | 4 | P-333-CS | - |
| 2x1.5x2 | 2R-F04N-SE | 1.5 | 3000 | 5.50 | 2.75 | 4.87 | 3.62 | .75 | .434 | .873 | 1.62 | 7.25 | 5.25 | 12.5 | P-4128-CS | 125 |
| 2x2x2 | 2F-F94N-SE | 2 | 2000 | 5.75 | 2.87 | 6.12 | 4.37 | .87 | .497 | .998 | 2 | 10.25 | 6.20 | 19 | P-4129-CS | - |